

# Multiple Sewershed Package 15: Pipe Burst & Open Cut Project CO-00611

Patrick O'Connor, P.E., PMP

Project Engineer II, Sewer and Water Pipeline

Roxanne Lockhart

Contract Administrator

Marisol V. Robles

SMWB Program Manager

Bryan Spina, P.E., CFM

Ardurra

Public Works Group Leader

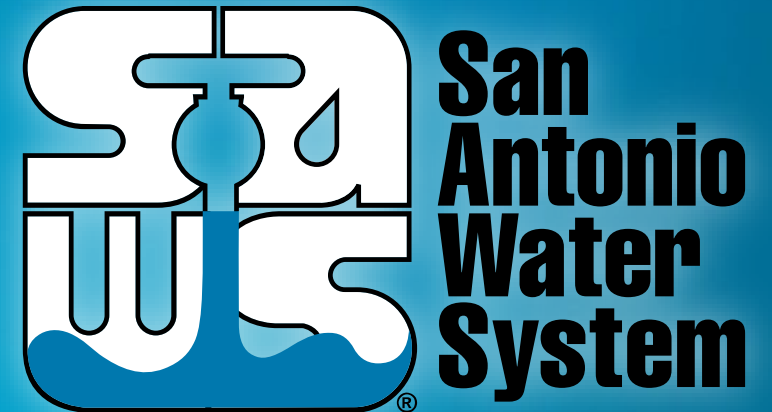

Non- Mandatory WebEx Pre-Bid Meeting

June 23, 2023

MAKING SAN ANTONIO  
**WATERFUL** 

# WebEx Reminders

- Stay muted during the entire presentation.
- Please sign-in using the chat feature with the following information:
  - Name, Company, Email Address
- Ask questions at any time during the presentation utilizing the Chat. Questions will be addressed at the end of the presentation.
  - Ensure to direct your questions to the entire group by selecting everyone from the drop down.
  - All formal responses to questions will be provided via an Addendum.
- Audio only attendees may follow along on the presentation posted to the SAWS solicitation website.

# Oral Statements

Oral statements or discussion during the pre-bid meeting today will not be binding, nor will it change or affect the terms or conditions within the Plans and Specifications of this Project. Changes, if any, will be addressed in writing only via an Addendum.



# Agenda

- General Information
- Non-Mandatory Site Visit
- SMWB Requirements
- Contract Solicitation Website
- Vendor Registration & Notification (VRN)
- Solicitation Schedule
- Contract Requirements
- Bid Packet Preparation
- Bid Opening Procedures
- Questions
- Restriction on Communication
- Contact Information
- Project Overview
- Project Details

# General Information

- This is a non-mandatory pre-bid meeting
- This presentation has been posted and the attendance sheet will be posted at the end of this meeting, to the SAWS website
- Construction services being procured through low bid under Chapter 2269 of the Texas Government Code
- A Geotechnical Report is available on the SAWS website and accessible once an electronic disclaimer form is signed
- Key Project Information:
  - Estimated Budget: \$2,000,000.00
  - Calendar Duration: 320 days

# Aspirational SMWB Goal

Industry	Aspirational SMWB Goal
Construction	25%

The aspirational SMWB goal is 25% of your total bid price

# Minimum Qualifications for SMWB recognition:

- South Central Texas Regional Certification Agency
  - Must be SBE-Certified (including MBEs and WBEs)
  - Texas Historically Underutilized Business “HUB” Program
- Local Office or Local Equipment Yard
  - Bexar, Comal, Guadalupe, Hays, Kendall, Travis, and Williamson counties.



# Good Faith Effort Plan (GFEP) FAQs

- **Q: Is the 25% SMWB goal mandatory?**

A: No, but we ask prime contractors to do their best with good faith outreach efforts. If the goal is not met, proof of outreach efforts is required with the submittal.

- **Q: What if I am having trouble finding SMWB subcontractors?**

A: The SCTRCA has a search portal at [www.sctrca.sctrca.org](http://www.sctrca.sctrca.org). Please make sure to include SAWS-specific parameters in your search. Contact Marisol Robles at [Marisol.Robles@saws.org](mailto:Marisol.Robles@saws.org) if assistance is needed.

- **Q: What if my business is SMWB-certified? Do I need to find SMWB subs?**

A: If your firm is SMWB-certified, you will most likely meet the goal. However, the GFEP is a required document, and a good faith outreach effort is still necessary.

- **Q: Do I need to include all my subcontractors in the GFEP or just those that qualify towards the SMWB goal?**

A: All subcontractors need to be included in the GFEP, even those that may not count towards the SMWB goal.

- **Q: What if I have questions about the GFEP?**

A: Please contact the SMWB Program Manager at [Marisol.Robles@saws.org](mailto:Marisol.Robles@saws.org). GFEP questions can be asked at any time before the submittal is due.



# Post Award: Subcontractor Payment & Utilization Reporting (S.P.U.R.) System

1. Subcontractor & Supplier Payment Tracking
2. Subcontractor and Supplier Additions or Substitutions
3. Must be Current and Accurate before Retainage is released

<https://saws.smwbe.com>



San Antonio Water System

OUR MAIN SITE CONTACT SUPPORT

## Subcontractor Payment & Utilization Reporting System

Log In

**System Training**  
Learn how to fully utilize our system with a live trainer  
Training

**About the System**  
Learn more about this system and how it works today  
Information for Vendors

**Account Access**  
Lookup Vendor accounts or reset user passwords  
Account Lookup  
Forgot Password

The Subcontractor Payment & Utilization Reporting System is powered by B2Gnow Software © Copyright 2018.

Multiple Sewershed Package 15: Pipe Burst and Open Cut

# Contract Solicitations Website

- To locate the Contract Solicitations, go to the SAWS website at [www.saws.org](http://www.saws.org), click on the drop-down menu for Resources and select Business Center, then Contract Solicitations.
- Highly recommend all firms be [registered](#) and to subscribe to each project to ensure access to the latest project information
- Choose the specific project by selecting “More”
- The following buttons are located under the advertisement:
  - Notify Me - Subscribe
  - Plan Holder’s List – View List
  - Downloads
    - Specifications
    - Plans
    - Addendums
    - Engineering Reports

# Solicitation Schedule

MILESTONE	DATE / TIME
Questions Due	June 27, 2023, at 2:00PM (CDT)
Answers Posted	July 10, 2023, at 2:00PM (CDT)
FTP Request Deadline	July 14, 2023, by 2:00PM (CDT)
Bids Due	July 17, 2023, by 2:00PM (CDT)
Lowest Responsible Bidder Notified	July/August 2023
Board Award	September 12, 2023



# Contract Requirements

## Prevailing Wage Rate and Labor Standards – Section 2.10 of the General Conditions

- Wage decisions are included within the specifications
- Contractors shall utilize LCP Tracker
- Certified payroll to be submitted on weekly basis beginning on the start date of the Notice to Proceed, including weeks in which work is not performed
- Contractors are responsible for sub-contractor payroll
- Late payrolls delay contractor payments, as well as release of retainage at the end of the project
- Payroll records are subject to review
- Site visits are random and unannounced
- Interviews will be conducted and will be private & confidential
- All apprenticeship programs will need to be approved by Department of Labor prior to starting



# Contract Requirements

- Insurance requirements are found in Section 5.7 of the GCs Supplemental Conditions
  - **Installation Floater insurance in lieu of Builder's Risk**
- Contractor's insurance must be compliant with all other contracts
- SAWWS will request insurance certificate prior to Board award to ensure insurance compliance and to assist in expediting execution of the contract
- Contractor must ensure insurance is compliant for the duration of the contract

# Contract Requirements

## Supplemental Conditions (Continued)

- Contractor shall perform the work with its own organization on at least 40% of the total original contract price which should be indicated on the Good Faith Effort Plan.

Type/s of Certification: SBE: \_\_\_\_\_ MBE: \_\_\_\_\_ VBE: \_\_\_\_\_ WBE: \_\_\_\_\_

Prime Contractor's Percentage of Participation: (Ex: 100% is the total value of the contract.) \_\_\_\_\_ %

Describe your firm's participation to be performed on this Project: \_\_\_\_\_

- Liquidated damages will be assessed at \$624.00 per day

# Bid Packet Preparation

- Only limited items are required with the initial bid packet
  - List of Bid Items
  - Bid Packet Checklist
  - Signed Bid Proposal Signature Page with
    - Acknowledgement of all Addenda
    - Executive Order
  - Signed Proposal Certification
  - Bid Bond
  - Good Faith Effort Plan

# Bid Packet Preparation

## Apparent Low Bidder

- Notified by SAWS within 24 hours of Bid Opening to provide the following within one (1) business day
  - Conflict of Interest Questionnaire - Form CIQ (Rev. 1/1/2021)
  - Proof of Insurability
  - Company Information Packet
  - Statement regarding ability to complete the project
  - W-9
  - Statement of Bidders Experience
  - Detailed Baseline Schedule using NTP date of September 25, 2023 (see Supplemental Condition)
- \*And, if bid was submitted electronically without a Bid Bond:
  - Cashier's Check or Certified Check



# Bid Packet Preparation

- Utilize the Bid Packet Checklist within the specifications
- Double check all mathematical calculations and verify all extensions
- Bidders must also enter a subtotal for Mob and then Preparation of ROW of all sites combined
- Ensure Mobilization & Prep ROW Line Item does not exceed the percentage allowed (lines 1-39)
- Addendums are acknowledged on the Bid Proposals
  - Check the SAWWS website regularly for addendum postings
  - It is possible to have multiple addendums

# Bid Opening Procedures

- Bids will be submitted using SAWS' electronic bid opening procedures
- SAWS encourages and prefers the submission of electronic bids using its secure FTP site.
  - Bidders should submit a request via email to obtain access to the site no later than 24 hours before the bid opening.
- Or, Bidders may drop off a hard copy bid. Only required items.
  - Drop box is located at 2800 US Hwy 281 N, Customer Service Tower
    - Enter the first set of glass double doors
    - Insert into the black drop box on the wall on the left-hand side
- Late bids will not be accepted and will not be opened.
- Bid Opening will be handled via WebEx only; reference the Invitation to Bidder's for the link

# Questions

- All questions should be sent in writing to the corresponding Contract Administrator by email [Roxanne.Lockhart@saws.org](mailto:Roxanne.Lockhart@saws.org) or fax, 210-233-4438.
- Please identify the project by its associated solicitation number.  
(CO-00611)

# Restriction on Communication

Please be advised that Bidders are prohibited from communicating with any other SAWS staff, the Consultant, or City of San Antonio officials regarding this IFB up until the contract is awarded as outlined in the Instructions to Bidders



# Contact Information

<u>Contact Name</u>	<u>Title</u>	<u>Telephone Number</u>	<u>Email address</u>
Roxanne Lockhart	Contract Administrator	210-233-3095	<a href="mailto:Roxanne.Lockhart@saws.org">Roxanne.Lockhart@saws.org</a>
Marisol V. Robles	SMWB Program Manager	210-233-3420	<a href="mailto:Marisol.Robles@saws.org">Marisol.Robles@saws.org</a>

# Project Location Map



SITE LOCATION MAPS

NTS

# Project Overview

## Items of Note

- Project consists of two (2) locations to rehabilitate or replace twelve (12) segments of sewer main. Both locations are located near or within Union Pacific Railroad (UPRR) Right-of-Way.
- The two locations are the I-35 & Whirlwind Dr site and the General Hudnell site.
- Projects consists of construction of approximately 949 LF of 8-inch open cut sewer main, 620 LF of 10-inch open cut sewer main, 68 LF of 24-inch open cut sewer main, 959 LF of 10-inch pipe-burst sewer main, and 100 LF of 42-inch jacking or boring within or adjacent to Union Pacific Railroad right-of-way.



# Contract Requirements

## Special Provisions

- Item 507 – Remove and Replace Fence: Establishes line item includes all types of fencing replacement required.
- Item 530 – Barricades, Signs and Traffic Handling: Establishes a lump sum item for each overall location.
- Item 540 – Temp Erosion, Sedimentation and SWP3 Controls: Establishes all related Work as a single “Lump Sum” item.
- Item 550 – Trench Excavation Safety Protection: Adds reference to trenching requirements and shoring required for working within UPRR right-of-way.
- Item 852 – Sanitary Sewer Manholes: Removes references to coatings no longer allowed.



# Contract Requirements

## Special Provisions

- Item 854 – Sanitary Sewer Laterals: Updates the Payment section.
- Item 862 – Abandonment of Sewer Main and Manholes: Updates the Measurement and Payment sections. Removal of debris and build-up accumulated within existing sanitary sewer mains necessary to complete abandonment is subsidiary.

# Contract Requirements

## Special Specifications

- Item SS-5000 – Settlement Monitoring: Provides direction on settlement monitoring required to monitor the tracks while conducting work within or crossing UPRR right-of-way and other locations noted in the plans.

# Contract Requirements

## Supplemental Conditions

- Contractor shall perform the work with its own organization on at least 40% of the total original contract price. This percentage should be reflected in the GFEP.
- Liquidated damages will be assessed as follows for final completion extending beyond contract time: \$624 per Day.
- Update to Article V – Contract Responsibilities to include Railroad Protective Liability insurance requirements.
- Includes any other supplemental conditions pertinent to the project.

# Contract Requirements

## Special Conditions

- Contractor shall meet requirements of Union Pacific Railroad (UPRR) Agreement for pipeline crossing and encroachments. Special Condition provides UPRR/RailPros contact information and documentation required before work can begin within UPRR right-of-way.
- The Contractor shall coordinate with UPRR and their consultant RailPros as per Special Condition SC3. Contractor shall note that coordination does take time to get all required submittals approved, so coordination shall begin as soon as the Notice-to-Proceed. All permits included in the contract documents.
- Locations will require some work within the City of San Antonio right-of-way. The contractor shall be responsible obtaining and complying with the City of San Antonio Right-of-Way permits and coordinating tree arborist inspections.
- Some utility poles may require bracing during construction and will be handled by SAWS Specification 3001.



# Contract Requirements

## Special Conditions

- Contractors shall note that CPS Energy does not allow the use of mechanical digging near gas transmission mains over 12” in diameter. Contractors shall hand dig or use hydro-excavation within 5’ of any gas transmission mains and notify CPS as per Special Condition SC9.
- Special Condition SC12 notes provides a summary of the right-of-entries to construct. Please note that two rights-of-entry to construct, 103 W. Greenway and 103 W. Emerson, could not be obtained.
- Please note that the right-of-entry to construct for 10201 N. Interstate 35 has a condition that uses the word “GRANTEE”. It shall be understood that the word GRANTEE refers to the CONTRACTOR and not SAWS or the Engineer.
- Special Condition SC13 for 106 W. Bedford will be discussed in detail later. Contractors should thoroughly read this special condition.

# Project Description and Details

## I-35 & Whirlwind Dr Site

- Consists of jacking and boring 100 LF of 42” casing with 24” carrier pipe, open cut replacing 688 LF of 10”-24” sewer main, and installing 7 Manholes.
- Jack and bore of 42” casing will be under UPRR tracks and across UPRR ROW
- The suggested bypass will run along the UPRR ROW and the existing sewer main.
- Access to the site is shown on Sheet S13 of the plans. All right-of-entries to construct have been acquired and included in the contract documents.
- Section to be open cut within the COSA/CPS Energy Property (Property ID 535657) will require the contractor to expose and protect an existing 24” gas line as per the notes in the plans.

# Project Description and Details

## I-35 & Whirlwind Dr Site Continued

- The section of sewer main in the back of the property at 9903 N. Interstate 35 runs within 7 feet of the building on the property. The contractor shall conduct settlement monitoring in the area and protect the building during open cut work as required by the plans and contract documents

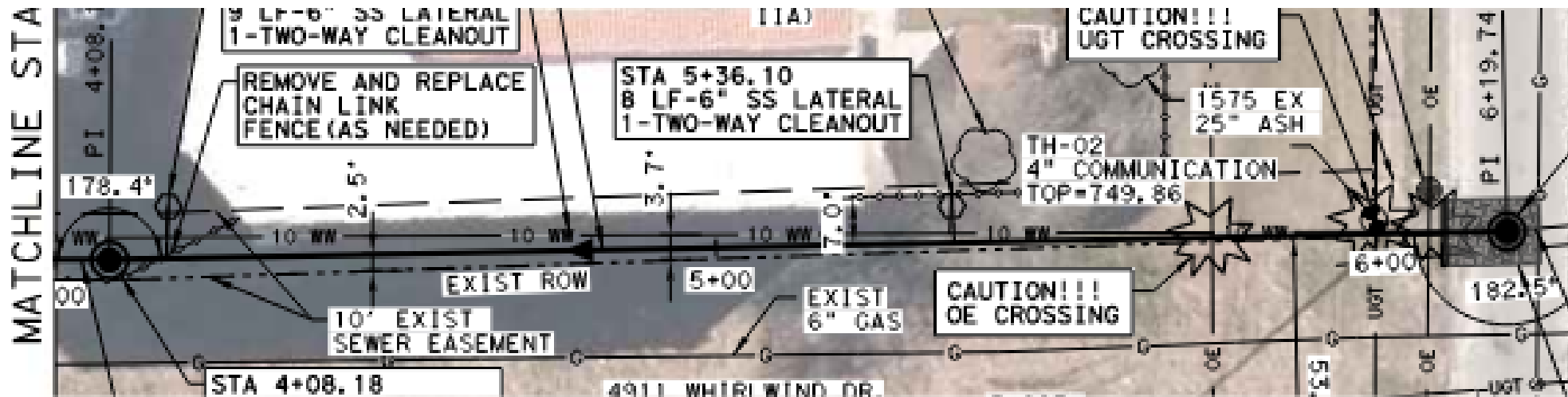

# Project Description and Details

## General Hudnell Site

- Consists of pipe-bursting 959 LF of 10” sewer main, open cut replacing 949 LF of 8” sewer main, installing 7 Manhole, and rehabbing 12.1 VF of existing manholes.
- A UPRR permit has been acquired to use the UPRR ROW for access to areas and to place bypass pumping piping. Please note the UPRR Permit requires the bypass pumping piping to be 6” HDPE.
- Please note that Right-of-Entries to Construct for 103 W. Emerson and 103 W. Greenway were not able to be obtained. If any work is required on these properties for point repairs, the contractor shall access the location from the UPRR ROW and keep all work within the existing 8’ sanitary sewer easement as noted in the plans and Special Condition SCI2. All other Right-of-Entries to Construct have been acquired.



# Project Description and Details

## General Hudnell Site: 106 W. Bedford

- The project will require the sewer main under 106 W. Bedford to be pipe-burst.
- Portions of the house were constructed within the existing 8' sewer easement and over the existing 10" sewer main.
- The existing properties sewer lateral lies under an existing concrete patio that will need to be removed and replaced.
- Contractors shall thoroughly read Special Condition SC13 of the Contract Documents outlining all requirements for pipe-bursting under 106 W. Bedford.
- SAWWS and LNV understand pipe-bursting of the 10" sewer main under the house may affect the house and foundation. For this reason, the Contractor will not be liable for any damages to the house so long as the Contractor acts in good faith to undertake efforts, in accordance with the Contractor's means and methods, that would generally be considered reasonable in avoiding or mitigating damage to the house at 106 W. Bedford Ave.

# Project Description and Details

## General Hudnell Site: 106 W. Bedford Continued

- As part of the good faith effort noted above, the Contractor shall provide a plan on how the Contractor will proceed with pipe-bursting under the house. This plan is required to be submitted and approved prior to construction on the sewer main under the house, and the plan will not be paid for separately and shall be subsidiary to the work.
- Settlement Monitoring will need to be conducted when pipe-bursting under the house.
- Prior to starting work on pipe-bursting under the house, the Contractor shall coordinate a meeting between the contractor, SAWS, the design engineer and landowner to inform the landowner of what to expect, timeline of construction, etc.

# Project Description and Details

## General Hudnell Site: 106 W. Bedford Continued

- A foundation study was conducted to locate all piers of the pier and beam foundation and establish a baseline for the existing structure. The report is included in the contract documents.
- SAWS has included a limited allowance for potential repairs needed to the house if any damage occurs during the work within and under the property.
- The existing properties sewer lateral lies under an existing concrete patio that will need to be removed and replaced.
- Contractors shall thoroughly read Special Condition SCI3 of the Contract Documents outlining all requirements for pipe-bursting under 106 W. Bedford.



# Project Description and Details

## General Hudnell Site: 106 W. Bedford Continued



Multiple Sewershed Package 15: Pipe Burst and Open Cut





# QUESTIONS?

*Reminder: Oral statements or discussion during the pre-bid meeting today will not be binding, nor will it change or affect the terms or conditions within the Plans and Specifications of this Project. Changes, if any, will be addressed in writing only via an Addendum.*

# Multiple Sewershed Package 15: Pipe Burst & Open Cut Project CO-00611

Patrick O'Connor, P.E., PMP

Project Engineer II, Sewer and Water Pipeline

Roxanne Lockhart

Contract Administrator

Marisol V. Robles

SMWB Program Manager

Bryan Spina, P.E., CFM

Ardurra

Public Works Group Leader



**San  
Antonio  
Water  
System**

Non- Mandatory WebEx Pre-Bid Meeting

June 23, 2023

MAKING SAN ANTONIO  
**WATERFUL** 